

Interior Signage Package

Hilton Garden Inn



"Boho" 2018 Standard

CONTACT US

Phone:
316.267.4171
Email:
dailyorders@identitygroup.com

IDENTITY GROUP IS AN APPROVED SIGNAGE SUPPLIER

NO FEE* PROJECT SERVICES

- Estimating
 - Planning - Wayfinding
 - Project Management
 - Evacuation Map Development
- * Requires minimum project values

DESIGN SERVICES AVAILABLE

COLORS / MATERIALS

Colors: There are 4 color scheme options available, shown in the graphic at right, along with 9 pattern options that are printed on the guestroom number only. The guestroom number is also available without a pattern to match the rest of the signage package. All signs with color options are displayed in the Blue color scheme within this brochure. The gray and white signage shown in the document is the brand standard for all common, back of house and exterior areas. Note: the color on these signs cannot be changed.

Materials: All signs requiring ADA Tactile copy and Braille are constructed with inlaid acrylic copy. Informational and Directional signs are made of reverse painted acrylic with printed copy and graphics

Font: HGI Standard Regular & Usual Regular.

COLOR OPTIONS



BLUE
PMS 7692C Blue
Backer & Text Color
White Face Color



AQUA
PMS 7465C Aqua
Backer & Text Color
White Face Color



ORANGE
PMS 166C Orange
Backer & Text Color
White Face Color



GRAY
PMS 11C Cool Gray 11
Backer & Text Color
White Face Color

GUEST ROOM NUMBER PATTERN OPTIONS

The graphic patterns shown below are available on the guest room numbers only.

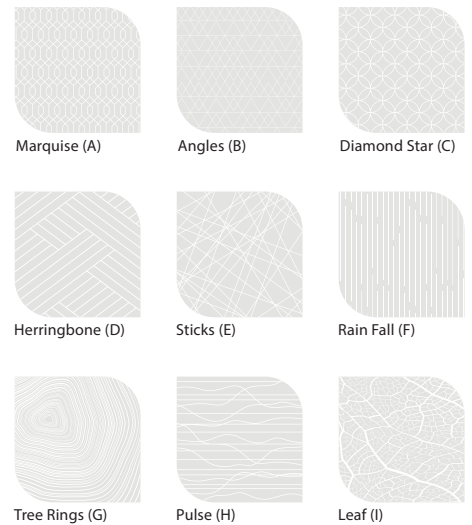

GUEST ROOM SIGNAGE



RM0505A HG18
(with face pattern)
RM0505B HG18
(without face pattern)
Guest Room Number
5-3/8" x 5-3/8"



RM0505S HG18
(with face pattern)
RM0505T HG18
(without face pattern)
Guest Room Number
With Symbol(s)
5-3/8" x 5-3/8"

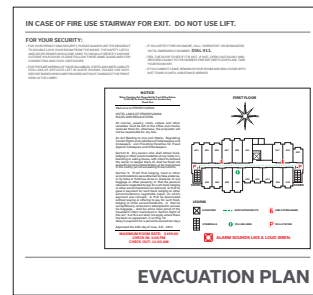

FE1312 HG18
Guest Room
Fire Evacuation
Plan Holder
12-7/8" x 12"

Guest Room
Fire Evacuation
Plan Insert
11" x 8-1/2"

IDENTIFICATION SIGNAGE



ID0904 HG18
Narrow 1-2 Line Public Room ID
(copy varies)
8-7/8" x 4-3/8"



ID1204 HG18
Wide 1-2 Line Public Room ID
(copy varies)
11-7/8" x 4-3/8"



ID0808 HG18
Narrow 3-4 Line
Public Room ID
(copy varies)
7-7/8" x 7-7/8"



ID1205 HG18
Wide 3 Line Public Room ID
(copy varies)
11-7/8" x 5-3/8"



ID1207 HG18
Wide 4 Line Public Room ID
(copy varies)
11-7/8" x 6-5/8"

Interior Signage Package

Hilton Garden Inn

IDENTIFICATION SIGNAGE *cont.*

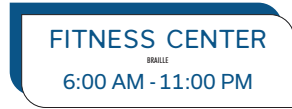

ID1204 HG18
Public Room ID With Hours
(copy varies)
11-7/8" x 4-3/8"



ID1212 HG18
Public Room ID With Informational Copy
(copy varies)
11-7/8" x 11-7/8"

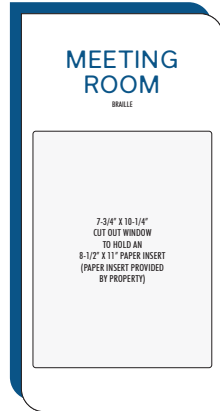

MT0918 HG18
Meeting Room ID
With Insert Holder
9-1/4" x 17-3/4"

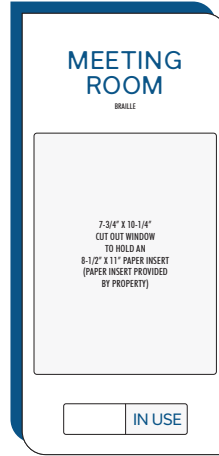

MT0919 HG18
Meeting Room ID
With Insert Holder
And In Use Slider
9-1/4" x 19-1/4"



RR0909 HG18
Public Restroom ID
(copy & symbols vary)
8-7/8" x 8-7/8"



MTG0808 HG18
Meeting Room ID
With In Use Slider
7-7/8" x 7-7/8"



ID0903 HG18
Narrow 1 Line Back Of
House /Ext Room ID
(copy varies)
8-7/8" x 3"



ID0904 HG18
Narrow 2 Line Back Of
House /Ext Room ID
(copy varies)
8-7/8" x 4"



ID0905 HG18
Narrow 3 Line Back Of
House /Ext Room ID
(copy varies)
8-7/8" x 5"



ID1203 HG18
Wide 1 Line Back Of
House /Ext Room ID
(copy varies)
11-7/8" x 3"



ID1204 HG18
Wide 2 Line Back Of
House /Ext Room ID
(copy varies)
11-7/8" x 4"



ID1205 HG18
Wide 3 Line Back Of
House /Ext Room ID
(copy varies)
11-7/8" x 5"

MEETING ROOM SIGNAGE

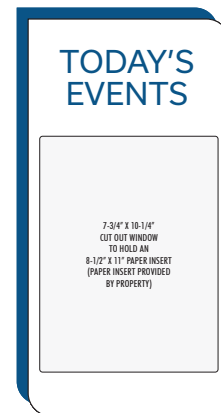

TE0918 HG18
Todays Events
With Insert Holder
9-1/4" x 17-3/4"

Interior Signage Package

Hilton Garden Inn

DIRECTIONAL SIGNAGE

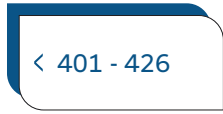

DR0904 HG18
Narrow 1-2 Line Directional
8-7/8" x 4-3/8"



DR1204 HG18
Wide 1-2 Line Directional
11-7/8" x 4-3/8"



DR1205 HG18
3 Line Directional
11-7/8" x 5-3/8"



DR1207 HG18
4 Line Directional
11-7/8" x 6-5/8"



DR1208 HG18
5 Line Directional
11-7/8" x 8-3/8"



DR1209 HG18
6 Line Directional
11-7/8" x 9-3/8"



DR1212 HG18
7-8 Line Directional
11-7/8" x 11-7/8"



DR1214 HG18
9-10 Line Directional
11-7/8" x 13-7/8"

INFORMATIONAL SIGNAGE



IF0604 HG18
Small Informational
6-3/8" x 3-7/8"



IF1212 HG18
Large Smoke Free Informational
11-7/8" x 11-7/8"

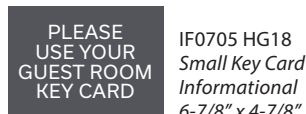

IF0705 HG18
Small Key Card Informational
6-7/8" x 4-7/8"

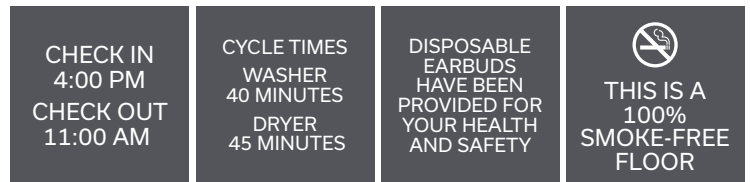

IF0808 HG18
Medium Informational
7-7/8" x 7-7/8"

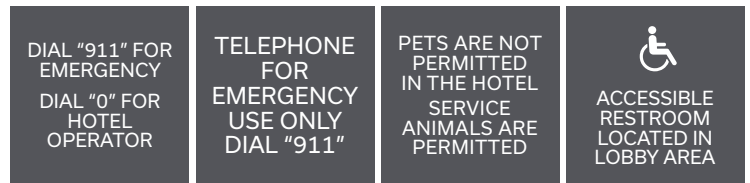

IF0803 HG18
Small Smoke Free Informational
7-1/2" x 2-1/2"

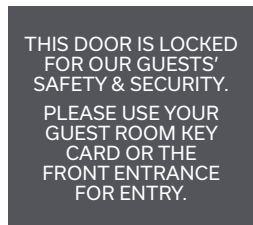

IF1110 HG18
Large Key Card Informational
10-7/8" x 9-7/8"

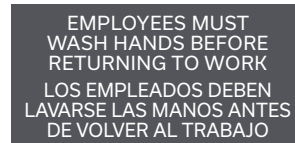
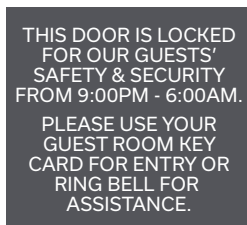

IF1306 HG18
Wash Hands Informational
13" x 6-3/8"

Interior Signage Package

Hilton Garden Inn

STAIR & ELEVATOR SIGNAGE



ST0808 HG18
Stair / Exit ID's
(copy & symbols vary)
7-7/8" x 7-7/8"



EL1111 HG18
In Case Of Fire
10-7/8" x 10-7/8"



FE1212 HG18
Elevator/Corridor
Fire Evacuation Plan
12" x 12-1/4"

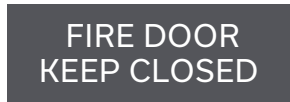

ST1304 HG18
Fire Door Informational
13" x 4-3/8"



ST0903 HG18
Interior Stairwell Level Identification
8-1/2" x 3"



ST1518 HG18
Interior Stairwell /Discharge Information
14-1/2" x 18"

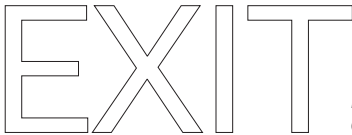

PV06 HG18
Exit Vinyl Copy
6" Tall Copy



G01-59095-0A HG18
Fire Door Vinyl Decal
9" x 4-1/4"



AR1111 HG18
Area Of Refuge Identification
(copy varies)
10-7/8" x 10-7/8"

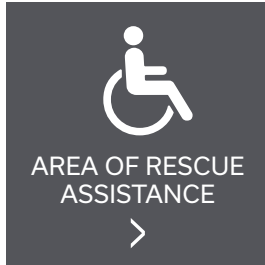

AR1111 HG18
Area Of Refuge Directional
(copy varies)
10-7/8" x 10-7/8"

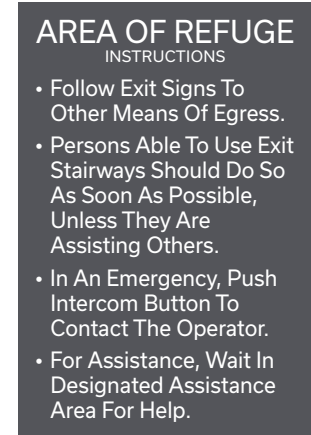

AR1319 HG18
Area Of Refuge Informational
12-3/4" x 18-3/4"

PROJECTION MOUNT SIGNAGE



PJ1708 HG18
Narrow Projection Mount
(2 Sided Sign)
(copy & graphics vary)
16-3/4" x 8"



PJ2308 HG18
Wide Projection Mount
(2 Sided Sign)
(copy & graphics vary)
22-34" x 8"

IDENTITY
GROUP

Interior Signage Package

Hilton Garden Inn

GUEST LAUNDRY SIGNAGE

Guest Laundry

For guest use only.

Not responsible for lost or damaged articles.
Use at your own risk.
Management does not provide an attendant for the operation of laundry equipment.
Read all operating instructions.
Do not leave personal property unattended.
No glass containers permitted.

RL2619 HG18
Guest Laundry Informational
25-5/8" x 18-5/8"

FITNESS CENTER SIGNAGE

Fitness Center

Center for use only by registered guests.

Use equipment at your own risk. Equipment for use by registered guests only.
No one under 18 years of age may use the equipment without adult supervision.
Follow all directions for use of equipment. Improper use can result in injury.

Do not use this equipment without doctor's permission.
Do not over-exercise.
Discontinue use at first signs of stress.
Fitness center is not supervised.
Do not exercise alone.

RL2619 HG18
Fitness Center Rules
25-5/8" x 18-5/8"

POOL & SPA SIGNAGE

SPA
TIMER

PL0604A HG18
Timer Informational
5-7/8" x 3-7/8"

EMERGENCY
SHUT-OFF
SWITCH

PL0604B HG18
Shut-Off Informational
6-3/8" x 3-7/8"



POOL LIFT

LF0808 HG18
Small Pool Lift
7-7/8" x 7-7/8"

DANGER:
Chlorine Inside

PV03 HG18
Danger Vinyl Copy
3" Tall Copy

POOL LIFT



Pool Lift Is For Use By Guests With Disabilities Only. All Other Uses Are Strictly Prohibited. Instructions For Pool Lift Use Located At Next To The Telephone. For Assistance With Lift, Please Contact The Front Desk.

LF2424 HG18
Large Pool Lift
(copy & symbols vary)
23-3/4" x 23-23/4"



RESERVED FOR GUESTS WITH MOBILITY DISABILITIES ONLY. FOR LIFT INSTRUCTIONS, CONTACT THE FRONT DESK.

EMERGENCY,
DIAL "911"
HOTEL OPERATOR,
DIAL "0"
GUEST ROOMS CANNOT
BE CALLED FROM
THIS TELEPHONE.

LF1212 HG18
Medium Pool Lift
(copy & symbols vary)
11-7/8" x 11-7/8"

PLEASE NOTE:

State and local codes may require your pool and spa area signage to have certain text, layouts and copy sizes specific to your area. If code-related signs are needed for your project, we will quote them in place of the brand standard signs.

Interior Signage Package

Hilton Garden Inn

POOL & SPA SIGNAGE *cont.*

Pool Rules

Pool Hours:

6:00 AM - 11:00 PM

Pool for registered guests only

No lifeguard on duty. Swim at your own risk.
NO DIVING OR JUMPING. Maximum pool depth 5' 10".
Maximum occupancy 28 people.
Owners and management not responsible for accidents or injury.
Non-swimmers and children under 16 must be accompanied by a responsible adult.
Glass containers prohibited. Do not swim alone.
Persons with communicable diseases shall not use pool.
Shower before entering pool.
Persons under the influence of alcohol or drugs shall not use the pool.
No running or horseplay.
No pets in pool area.
Report any unsafe conditions to management immediately.
In Case of an Emergency Dial "911"

PL2933 HG18
Pool Rules
28-5/8" x 32-7/8"

Spa Rules

For your safety, please observe.

Pregnant women and persons with heart disease, diabetes, high or low blood pressure, or other medical conditions should not enter the Spa/Hot Tub without prior medical consultation with and permission of their doctor.
DO NOT use the Spa/Hot Tub while under the influence of alcohol, narcotics, or other drugs.
Use of the Spa/Hot Tub by yourself is not recommended.
Enter or exit slowly and watch your step.

Observe reasonable time limits to avoid nausea or dizziness.
Keep glass or breakable objects out of the Spa/Hot Tub area.
Unsupervised use of the Spa/Hot Tub by children is prohibited.
No pets.
Please do not leave valuables unattended. Management is not responsible for lost or missing items.

SP3216 HG18
Spa Rules
31-3/4" x 15-3/4"



NO DIVING

NO LIFE GUARD ON DUTY

PL3325 HG18
No Diving/No Lifeguard
33" x 24-1/2"

EXTERIOR & PARKING AREA SIGNAGE

CLEARANCE 15"-10"

CL06 HG18 - EXT
Clearance Copy & Numbers
6" Tall Copy

PARKING
FOR HOTEL
GUESTS ONLY

User Assumes
All Risks

All Valuables Should Be
Removed From Vehicle.
Owner & Management
Are Not Liable For Loss
Or Damages.

PK1218 HG18 - EXT
Parking Liability Notice
12" x 18"

RESERVED
FOR ELECTRIC
VEHICLES



CHARGING
STATION

PK1218 HG18 - EXT
Electric Vehicle Parking
12" x 18"



PARKING

PRK1218 GSI - EXT
Accessible Parking
12" x 18"

1832

AD06 HG18 - EXT
Address Copy & Numbers
6" Tall Copy

VAN
ACCESSIBLE

PRK1206 GSI - EXT
Van Accessible
12" x 6"

IDENTITY GROUP