

# Interior Signage Package

## Hilton Garden Inn



"Elevate" 2018 Standard

### CONTACT US

Phone:  
316.267.4171  
Email:  
dailyorders@identitygroup.com

**IDENTITY GROUP IS AN APPROVED SIGNAGE SUPPLIER**

### NO FEE\* PROJECT SERVICES

- Estimating
  - Planning - Wayfinding
  - Project Management
  - Evacuation Map Development
- \* Requires minimum project values

### DESIGN SERVICES AVAILABLE

### COLORS / MATERIALS

**Colors:** There are 3 color scheme options available, shown in the graphic at right, along with 9 pattern options that are printed on the guestroom number only. The guestroom number is also available without a pattern to match the rest of the signage package. All signs with color options are displayed in the Aged Bronze color scheme within this brochure. The gray and white signage shown in the document is the brand standard for all common, back of house and exterior areas. Note: the color on these signs cannot be changed.

**Materials:** All signs requiring ADA Tactile copy and Braille are constructed with inlaid acrylic copy. Informational and Directional signs are made of reverse painted acrylic with printed copy and graphics

**Font:** HGI Standard Regular & Usual Regular.

Rev. 04-19-22

### COLOR OPTIONS



**AGED BRONZE**  
PMS 8620C  
Metallic Bronze  
Backer & Text Color  
White Face Color

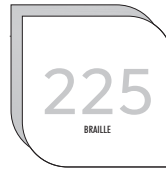

**BRUSHED TINSEL**  
PMS 877C  
Brushed Aluminum  
Backer & Text Color  
White Face Color



**STEEL WOOL**  
MAP 20307  
Warm Metallic  
Charcoal  
Backer & Text Color  
White Face Color

### GUEST ROOM NUMBER PATTERN OPTIONS

The graphic patterns shown below are available on the guest room numbers only.

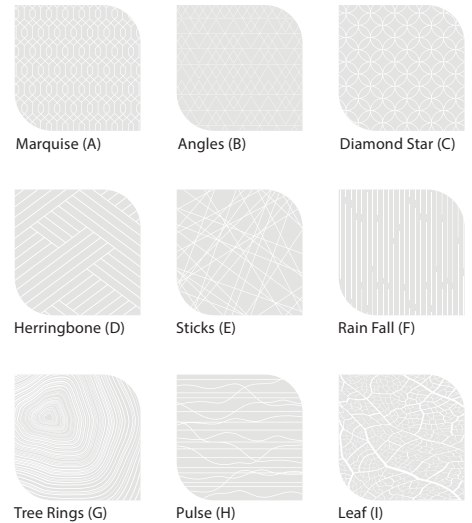

### GUEST ROOM SIGNAGE



RM0505A HG18  
(with face pattern)  
RM0505B HG18  
(without face pattern)  
Guest Room Number  
5-3/8" x 5-3/8"



RM0505S HG18  
(with face pattern)  
RM0505T HG18  
(without face pattern)  
Guest Room Number  
With Symbol(s)  
5-3/8" x 5-3/8"

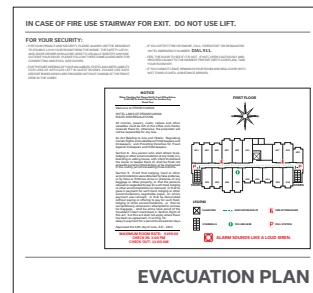

FE1312 HG18  
Guest Room  
Fire Evacuation  
Plan Holder  
12-7/8" x 12"  
  
Guest Room  
Fire Evacuation  
Plan Insert  
11" x 8-1/2"

### IDENTIFICATION SIGNAGE



ID0904 HG18  
Narrow 1-2 Line Public Room ID  
(copy varies)  
8-7/8" x 4-3/8"



ID1204 HG18  
Wide 1-2 Line Public Room ID  
(copy varies)  
11-7/8" x 4-3/8"



ID0808 HG18  
Narrow 3-4 Line  
Public Room ID  
(copy varies)  
7-7/8" x 7-7/8"



ID1205 HG18  
Wide 3 Line Public Room ID  
(copy varies)  
11-7/8" x 5-3/8"

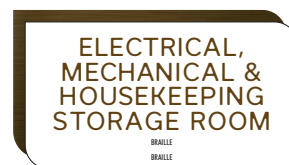

ID1207 HG18  
Wide 4 Line Public Room ID  
(copy varies)  
11-7/8" x 6-5/8"



# Interior Signage Package

## Hilton Garden Inn

### IDENTIFICATION SIGNAGE *cont.*



ID1204 HG18  
Public Room ID With Hours  
(copy varies)  
11-7/8" x 4-3/8"



ID1212 HG18  
Public Room ID With Informational Copy  
(copy varies)  
11-7/8" x 11-7/8"

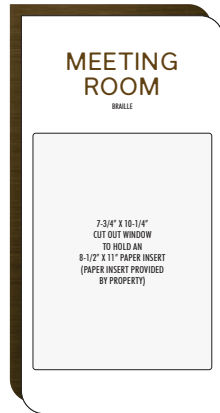

MT0918 HG18  
Meeting Room ID  
With Insert Holder  
9-1/4" x 17-3/4"



MT0919 HG18  
Meeting Room ID  
With Insert Holder  
And In Use Slider  
9-1/4" x 19-1/4"



RR0909 HG18  
Public Restroom ID  
(copy & symbols vary)  
8-7/8" x 8-7/8"



MTG0808 HG18  
Meeting Room ID  
With In Use Slider  
7-7/8" x 7-7/8"



ID0903 HG18  
Narrow 1 Line Back Of House /Ext Room ID  
(copy varies)  
8-7/8" x 3"



ID0904 HG18  
Narrow 2 Line Back Of House /Ext Room ID  
(copy varies)  
8-7/8" x 4"



ID0905 HG18  
Narrow 3 Line Back Of House /Ext Room ID  
(copy varies)  
8-7/8" x 5"



ID1203 HG18  
Wide 1 Line Back Of House /Ext Room ID  
(copy varies)  
11-7/8" x 3"



ID1204 HG18  
Wide 2 Line Back Of House /Ext Room ID  
(copy varies)  
11-7/8" x 4"



ID1205 HG18  
Wide 3 Line Back Of House /Ext Room ID  
(copy varies)  
11-7/8" x 5"

### MEETING ROOM SIGNAGE

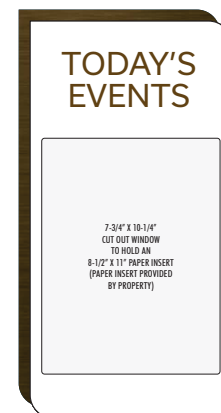

TE0918 HG18  
Todays Events  
With Insert Holder  
9-1/4" x 17-3/4"

# Interior Signage Package

Hilton Garden Inn

## DIRECTIONAL SIGNAGE

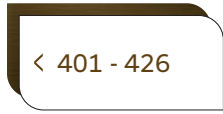

DR0904 HG18  
Narrow 1-2 Line Directional  
8-7/8" x 4-3/8"



DR1204 HG18  
Wide 1-2 Line Directional  
11-7/8" x 4-3/8"



DR1205 HG18  
3 Line Directional  
11-7/8" x 5-3/8"



DR1207 HG18  
4 Line Directional  
11-7/8" x 6-5/8"



DR1208 HG18  
5 Line Directional  
11-7/8" x 8-3/8"



DR1209 HG18  
6 Line Directional  
11-7/8" x 9-3/8"



DR1212 HG18  
7-8 Line Directional  
11-7/8" x 11-7/8"

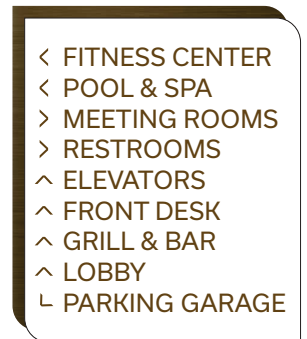

DR1214 HG18  
9-10 Line Directional  
11-7/8" x 13-7/8"

## INFORMATIONAL SIGNAGE



IF0604 HG18  
Small Informational  
6-3/8" x 3-7/8"



IF1212 HG18  
Large Smoke Free Informational  
11-7/8" x 11-7/8"

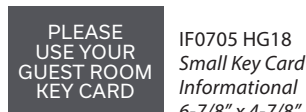

IF0705 HG18  
Small Key Card Informational  
6-7/8" x 4-7/8"

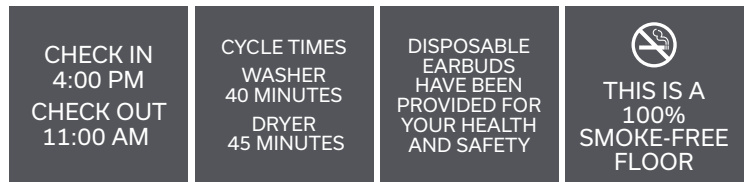

IF0808 HG18  
Medium Informational  
7-7/8" x 7-7/8"

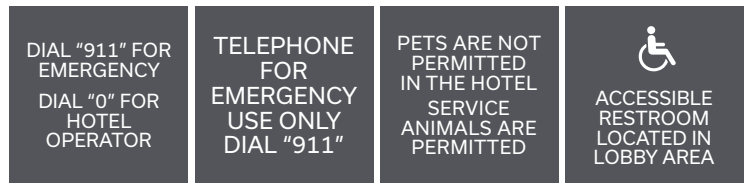

IF1306 HG18  
Wash Hands Informational  
13" x 6-3/8"

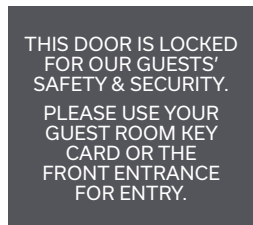

IF1110 HG18  
Large Key Card Informational  
10-7/8" x 9-7/8"

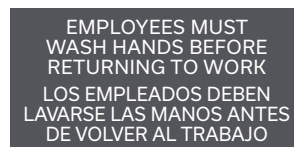
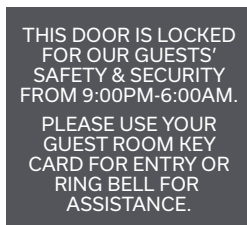

IF0803 HG18  
Small Smoke Free Informational  
7-1/2" x 2-1/2"

# Interior Signage Package

Hilton Garden Inn

## STAIR & ELEVATOR SIGNAGE



ST0808 HG18  
Stair / Exit ID's  
(copy & symbols vary)  
7-7/8" x 7-7/8"



EL1111 HG18  
In Case Of Fire  
10-7/8" x 10-7/8"

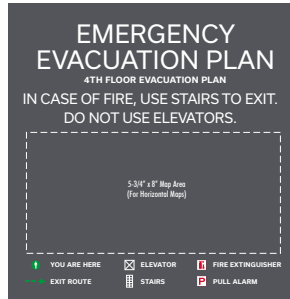

FE1212 HG18  
Elevator/Corridor  
Fire Evacuation Plan  
12" x 12-1/4"

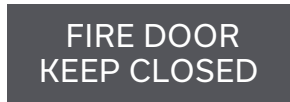

ST1304 HG18  
Fire Door Informational  
13" x 4-3/8"



ST0903 HG18  
Interior Stairwell Level Identification  
8-1/2" x 3"



ST1518 HG18  
Interior Stairwell /Discharge Information  
14-1/2" x 18"

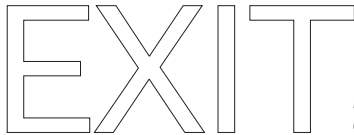

PV06 HG18  
Exit Vinyl Copy  
6" Tall Copy



G01-59095-0A HG18  
Fire Door Vinyl Decal  
9" x 4-1/4"



AR1111 HG18  
Area Of Refuge Identification  
(copy varies)  
10-7/8" x 10-7/8"

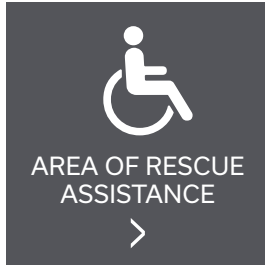

AR1111 HG18  
Area Of Refuge Directional  
(copy varies)  
10-7/8" x 10-7/8"

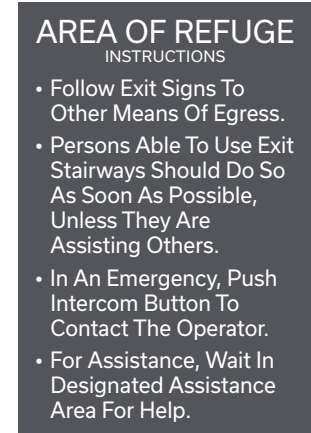

AR1319 HG18  
Area Of Refuge Informational  
12-3/4" x 18-3/4"

## PROJECTION MOUNT SIGNAGE



PJ1708 HG18  
Narrow Projection Mount  
(2 Sided Sign)  
(copy & graphics vary)  
16-3/4" x 8"



PJ2308 HG18  
Wide Projection Mount  
(2 Sided Sign)  
(copy & graphics vary)  
22-34" x 8"

# Interior Signage Package

Hilton Garden Inn

## GUEST LAUNDRY SIGNAGE

### Guest Laundry

For guest use only.

Not responsible for lost or damaged articles.  
Use at your own risk.  
Management does not provide an attendant for the operation of laundry equipment.  
Read all operating instructions.  
Do not leave personal property unattended.  
No glass containers permitted.

RL2619 HG18  
*Guest Laundry Informational*  
25-5/8" x 18-5/8"

## FITNESS CENTER SIGNAGE

### Fitness Center

Center for use only by registered guests.

Use equipment at your own risk. Equipment for use by registered guests only.  
No one under 18 years of age may use the equipment without adult supervision.  
Follow all directions for use of equipment. Improper use can result in injury.

Do not use this equipment without doctor's permission.  
Do not over-exercise.  
Discontinue use at first signs of stress.  
Fitness center is not supervised.  
Do not exercise alone.

RL2619 HG18  
*Fitness Center Rules*  
25-5/8" x 18-5/8"

## POOL & SPA SIGNAGE

SPA  
TIMER

PL0604A HG18  
*Timer Informational*  
5-7/8" x 3-7/8"

EMERGENCY  
SHUT-OFF  
SWITCH

PL0604B HG18  
*Shut-Off Informational*  
6-3/8" x 3-7/8"



POOL LIFT

LF0808 HG18  
*Small Pool Lift*  
7-7/8" x 7-7/8"

**DANGER:**  
**Chlorine Inside**

PV03 HG18  
*Danger Vinyl Copy*  
3" Tall Copy

## POOL LIFT



Pool Lift Is For Use By Guests With Disabilities Only. All Other Uses Are Strictly Prohibited. Instructions For Pool Lift Use Located At Next To The Telephone. For Assistance With Lift, Please Contact The Front Desk.

LF2424 HG18  
*Large Pool Lift*  
(copy & symbols vary)  
23-3/4" x 23-23/4"



RESERVED FOR GUESTS WITH MOBILITY DISABILITIES ONLY. FOR LIFT INSTRUCTIONS, CONTACT THE FRONT DESK.

EMERGENCY,  
DIAL "911"

HOTEL OPERATOR,  
DIAL "0"

GUEST ROOMS CANNOT  
BE CALLED FROM  
THIS TELEPHONE.

LF1212 HG18  
*Medium Pool Lift*  
(copy & symbols vary)  
11-7/8" x 11-7/8"

## PLEASE NOTE:

State and local codes may require your pool and spa area signage to have certain text, layouts and copy sizes specific to your area. If code-related signs are needed for your project, we will quote them in place of the brand standard signs.

# Interior Signage Package

Hilton Garden Inn

## POOL & SPA SIGNAGE *cont.*

# Pool Rules

### Pool Hours:

6:00 AM - 11:00 PM

Pool for registered guests only

No lifeguard on duty. Swim at your own risk.  
NO DIVING OR JUMPING. Maximum pool depth 5' 10".  
Maximum occupancy 28 people.  
Owners and management not responsible for accidents or injury.  
Non-swimmers and children under 16 must be accompanied by a responsible adult.  
Glass containers prohibited. Do not swim alone.  
Persons with communicable diseases shall not use pool.  
Shower before entering pool.  
Persons under the influence of alcohol or drugs shall not use the pool.  
No running or horseplay.  
No pets in pool area.  
Report any unsafe conditions to management immediately.  
  
In Case of an Emergency Dial "911"

PL2933 HG18  
Pool Rules  
28-5/8" x 32-7/8"

# Spa Rules

For your safety, please observe.

Pregnant women and persons with heart disease, diabetes, high or low blood pressure, or other medical conditions should not enter the Spa/Hot Tub without prior medical consultation with and permission of their doctor.  
DO NOT use the Spa/Hot Tub while under the influence of alcohol, narcotics, or other drugs.  
Use of the Spa/Hot Tub by yourself is not recommended.  
Enter or exit slowly and watch your step.

Observe reasonable time limits to avoid nausea or dizziness.  
Keep glass or breakable objects out of the Spa/Hot Tub area.  
Unsupervised use of the Spa/Hot Tub by children is prohibited.  
No pets.  
Please do not leave valuables unattended. Management is not responsible for lost or missing items.

SP3216 HG18  
Spa Rules  
31-3/4" x 15-3/4"



# NO DIVING

# NO LIFE GUARD ON DUTY

PL3325 HG18  
No Diving/No Lifeguard  
33" x 24-1/2"

## EXTERIOR & PARKING AREA SIGNAGE

# CLEARANCE 15"-10"

CL06 HG18 - EXT  
Clearance Copy & Numbers  
6" Tall Copy

PARKING  
FOR HOTEL  
GUESTS ONLY

User Assumes  
All Risks

All Valuables Should Be  
Removed From Vehicle.  
Owner & Management  
Are Not Liable For Loss  
Or Damages.

PK1218 HG18 - EXT  
Parking Liability Notice  
12" x 18"

RESERVED  
FOR ELECTRIC  
VEHICLES



CHARGING  
STATION

PK1218 HG18 - EXT  
Electric Vehicle Parking  
12" x 18"



PRK1218 GSI - EXT  
Accessible Parking  
12" x 18"

# 1832

AD06 HG18 - EXT  
Address Copy & Numbers  
6" Tall Copy

VAN  
ACCESSIBLE

PRK1206 GSI - EXT  
Van Accessible  
12" x 6"

# IDENTITY GROUP